

jinton 金通

JTPR®

Best quality ☉ Cross the world



金通管业

山东金通管业有限公司
SHANDONG JINTONG PIPELINE CO.,LTD



Brief Introduction

山东金通管业有限公司位于国际风筝都—山东省潍坊市，占地面积70000多平方米，公司现有员工380名，研发技术人员26名，其中高级工程师6名，工程师12名，助理工程师8名。是一家专业从事沟槽管件、涂塑钢管、阀门等系列产品的设计、研发、生产、销售为一体的现代化企业。产品广泛用于消防、电力、电信、市政建设、化工、煤矿等。

公司已通过FM认证、UL认证和ISO9001质量管理体系认证，自动造型浇注线、涂塑管件生产线、浸塑管道生产线、静电喷涂生产线，已形成沟槽式管道10万吨、热浸塑管道10万吨的年生产能力。先后与武汉大学、山东大学及多家设计院合作开发了超高分子耐磨管道、超耐磨陶瓷管道、管件等产品。公司拥有独立的科研机构和实验室，配备了炉前铁水自动分析仪、智能数显碳硫自动分析仪、金相分析仪、型砂检验设备、电子万能试验机等先进的检测设备。产品已通过国家固定灭火系统和耐火构件质量监督检验中心的型式检验、国家电力工业电气设备质量检验测试中心的测试，获得国家矿用产品安全标志中心颁发的煤矿产品安全证书及国家多项专利和国家高新技术成果奖。2011年获山东省高新技术企业。

公司产品质量由中国平安财产保险股份有限公司承保，畅销国内30多个省、市、自治区并出口日本、印度、以色列、阿联酋等国家和地区。

公司依托先进科学技术、优质的产品质量和持续创新的能力，生产规模不断扩大，以振兴民族工业为崇高使命，节约人类宝贵资源为己任，为顾客创优质产品。与新老客户携手共进，共同塑造管道行业一流品牌。



Shandong Jintong Pipeline Co., Ltd is located in Weifang city Shandong province, it covers an area of 70,000 square meters, own 380 staffs, among which 26 are R&D members. Its main products are grooved fittings, powder coated steel pipes and valves, which are widely used in many fields such as fire fighting, electric power, telecom, municipal construction, chemical, mine etc.

Jintong obtained FM approvals, UL certificate and ISO9001 certificate. It imports advanced production line such as DISA line, pipe fitting production line, powder coated pipe production line, electrostatic coating production line. Production ability is 100,000 tons for grooved fittings and 100,000 tons for coated pipes per year. The company cooperates with Wuhan University, Shandong University and many other design institutes to develop ultra high molecular wearing pipe, wearing ceramic pipe and fittings. It has its own R&D system and lab, equipped with advanced inspection and detection equipment, such as hot metal auto analyzer, intelligent digital carbon sulfur analyzer, metallographic analyzer, sand test equipment and universal material testing machine and so on. Jintong products are verified by National Fixed Fire-fighting System and Fire-proof Parts Quality Testing Center, National Mine Products Safety Center, National Electric Power Industry Electrical Equipment Quality Testing Center. Jintong also gets many national patents and high & new technology achievements, It is awarded Shandong high & new technology enterprise in 2011.

Jintong products are very popular in China market in more than 30 provinces and cities, exported to Japan, India, Israel, The United Arab Emirates and other countries.

Jintong company is ready to do business with new and old costumers around the world.





企业荣誉 Qualifications



技术与装备 Techniques and Equipments

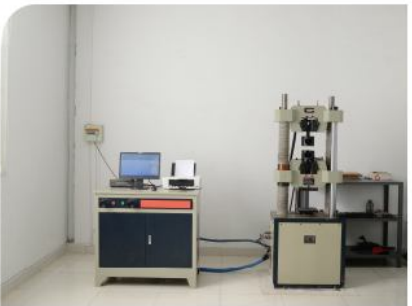



产品展示 Products show



刚性卡箍
Rigid Coupling



柔性卡箍
Flexible Coupling



沟槽式机械三通
Mechanical Tee Grooved outlet



螺纹式机械三通
Mechanical Tee Threaded outlet



U型栓机械三通
U-Bolt Mechanical Tee



沟槽法兰
Grooved flange



90° 弯头
90° Elbow



45° 弯头
45° Elbow



22.5° 弯头
22.5° Elbow



11.25° 弯头
11.25° Elbow

Color Choice



红色
Red



橘色
Orange



蓝色
Blue



银色
Galvanized/Dacromet



正三通
Tee



沟槽式异径三通
Grooved Reducing Tee



螺纹式异径三通
Threaded Reducing Tee



正四通
Cross



沟槽式异径四通
Grooved Reducing Cross



螺纹式异径四通
Threaded Reducing Cross



盲片
Cap



沟槽式大小头
Grooved Concentric Reducer



螺纹式大小头
Threaded Concentric Reducer



沟槽式偏心大小头
Grooved Eccentric Reducer



转换法兰
Adaptor Flange



Rigid Coupling
刚性卡箍
XGQT1

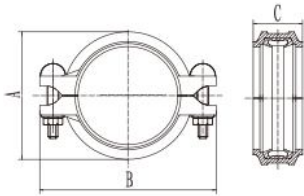

Nominal Size mm/in	Pipe OD. mm/in	Working Pressure psi/Mpa	Dimensions mm/in			Bolt Size
			A mm/in	B mm/in	C mm/in	No.-Size mm
规格	管子基本尺寸	工作压力	尺寸			螺栓
25 1	33.7 1.327	300 psi 2.07 Mpa	56 2.20	98 3.85	44 1.74	3/8*45-2
32 1¼	42.4 1.669		65 2.55	108 4.25	44 1.74	3/8*45-2
40 1½	48.3 1.9		72 2.84	114 4.48	44 1.74	3/8*45-2
50 2	60.3 2.375		84 3.30	126 4.96	46 1.81	3/8*55-2
65 2½	73 2.875		97 3.81	140 5.52	46 1.81	3/8*55-2
65 2½	76.1 3		100 3.93	142 5.59	46 1.81	3/8*55-2
80 3	88.9 3.5		114 4.48	154 6.06	46 1.81	3/8*55-2
100 4	108 4.25		135 5.31	186 7.32	50 1.96	1/2*65-2
100 4	114.3 4.5		138 5.43	192 7.55	50 1.96	1/2*65-2
125 5	133 5.25		162 6.37	213 8.38	50 1.96	1/2*75-2
125 5	139.7 5.5		170 6.73	220 8.66	50 1.96	1/2*75-2
125 5	141.3 5.563		171 6.73	222 8.74	50 1.96	1/2*75-2
150 6	159 6.25		190 7.48	241 9.48	50 1.96	1/2*75-2
150 6	165.1 6.5		196 7.71	248 9.76	50 1.96	1/2*75-2
150 6	168.3 6.625		200 7.87	252 9.92	50 1.96	1/2*75-2
200 8	219.1 8.625		258 10.15	322 12.67	60 2.36	5/8*95-2
250 10	273 10.75		318 12.51	400 15.74	62 2.44	3/4*110-2
300 12	323.9 12.750		372 14.64	454 17.87	64 2.51	3/4*120-2

注：产品尺寸可能会因技术原因有所改动，恕不另行通知，如有疑问请垂询金通管业技术部

The measurements of products maybe changed for the technical reason without responsibility note, please feel free to contact technical Dept.

Flexible Coupling

挠性卡箍

XGQT2

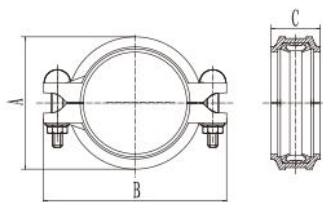

Nominal Size mm/in	Pipe OD. mm/in	Working Pressure psi/Mpa	Dimensions mm/in			Bolt Size
			A mm/in	B mm/in	C mm/in	No.-Size mm
规格	管子基本尺寸	工作压力	尺寸			螺栓
25 1	33.7 1.327	300 psi 2.07 Mpa	56 2.20	98 3.85	44 1.74	3/8*45-2
32 1¼	42.4 1.669		65 2.55	108 4.25	44 1.74	3/8*45-2
40 1½	48.3 1.9		72 2.84	114 4.48	44 1.74	3/8*45-2
50 2	60.3 2.375		84 3.30	126 4.96	46 1.81	3/8*55-2
65 2½	73 2.875		97 3.81	140 5.52	46 1.81	3/8*55-2
65 2½	76.1 3		100 3.93	142 5.59	46 1.81	3/8*55-2
80 3	88.9 3.5		114 4.48	154 6.06	46 1.81	3/8*55-2
100 4	108 4.25		135 5.31	186 7.32	50 1.96	1/2*65-2
100 4	114.3 4.5		138 5.43	192 7.55	50 1.96	1/2*65-2
125 5	133 5.25		162 6.37	213 8.38	50 1.96	1/2*75-2
125 5	139.7 5.5		170 6.73	220 8.66	50 1.96	1/2*75-2
125 5	141.3 5.563		171 6.73	222 8.74	50 1.96	1/2*75-2
150 6	159 6.25		190 7.48	241 9.48	50 1.96	1/2*75-2
150 6	165.1 6.5		196 7.71	248 9.76	50 1.96	1/2*75-2
150 6	168.3 6.625		200 7.87	252 9.92	50 1.96	1/2*75-2
200 8	219.1 8.625		258 10.15	322 12.67	60 2.36	5/8*95-2
250 10	273 10.75		318 12.51	400 15.74	62 2.44	3/4*110-2
300 12	323.9 12.750		372 14.64	454 17.87	64 2.51	3/4*120-2

注：产品尺寸可能会因技术原因有所改动，恕不另行通知，如有疑问请垂询金通管业技术部

The measurements of products may be changed for the technical reason without responsibility note, please feel free to contact technical Dept.

Mechanical Tee Grooved outlet

沟槽式机械三通

XGQT3

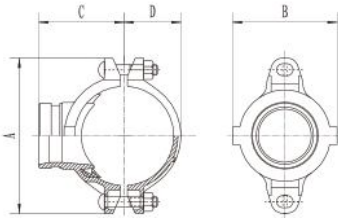

Nominal Size mm/in	Pipe OD. mm/in	Working Pressure psi/Mpa	Hole Dia. Mm/in +1.6,0/+0.063,0	Dimensions mm/in				Bolt Size
				A	B	C	D	
规格	管子基本尺寸	工作压力	开孔尺寸	A	B	C	D	螺栓规格
50 × 25 2 × 1	60.3 × 33.7 2.375 × 1.315	300 psi 2.07 Mpa	38 1.50	118 4.64	71 2.80	69 2.71	40 1.57	3/8*55-2
50 × 32 2 × 1¼	60.3 × 42.4 2.375 × 1.660		46 1.81	118 4.64	75 2.95	69 2.71	40 1.57	3/8*55-2
50 × 40 2 × 1½	60.3 × 48.3 2.375 × 1.900		46 1.81	118 4.64	75 2.95	69 2.71	40 1.57	3/8*55-2
65 × 25 2½ × 1	73.0 × 33.7 2.875 × 1.315		38 1.50	133 5.23	72 2.83	77 3.03	47 1.85	3/8*55-2
65 × 32 2½ × 1¼	73.0 × 42.4 2.875 × 1.660		46 1.81	133 5.23	81 3.18	77 3.03	47 1.85	3/8*55-2
65 × 40 2½ × 1½	73.0 × 48.3 2.875 × 1.900		53 2.08	133 5.23	86 3.38	77 3.03	47 1.85	3/8*55-2
65 × 25 2½ × 1	76.1 × 33.7 3.000 × 1.315		38 1.50	136 5.35	72 2.83	78 3.07	49 1.93	3/8*55-2
65 × 32 2½ × 1¼	76.1 × 42.4 3.000 × 1.660		46 1.81	136 5.35	81 3.18	78 3.07	49 1.93	3/8*55-2
65 × 40 2½ × 1½	76.1 × 48.3 3.000 × 1.900		53 2.08	136 5.35	86 3.38	78 3.07	49 1.93	3/8*55-2
80 × 25 3 × 1	88.9 × 33.7 3.500 × 1.315		38 1.50	150 5.98	73 2.87	85 3.33	56 2.20	3/8*55-2
80 × 32 3 × 1¼	88.9 × 42.4 3.500 × 1.660		46 1.81	150 5.98	82 3.22	85 3.33	56 2.20	3/8*55-2
80 × 40 3 × 1½	88.9 × 48.3 3.500 × 1.900		53 2.08	150 5.90	87 3.42	85 3.33	56 2.20	3/8*55-2
80 × 50 3 × 2	88.9 × 60.3 3.500 × 2.375		61 2.40	150 5.90	100 3.93	85 3.33	56 2.20	3/8*55-2
80 × 65 3 × 2½	88.9 × 73.0 3.500 × 2.875		61 2.40	150 5.90	100 3.93	85 3.33	56 2.20	3/8*55-2
80 × 65 3 × 2½	88.9 × 76.1 3.500 × 3.000		61 2.40	150 5.90	100 3.93	85 3.33	56 2.20	3/8*55-2
100 × 50 4 × 2	108.0 × 60.3 4.250 × 2.375		61 2.40	172 6.77	106.5 4.19	92 3.78	64.5 2.54	1/2*65-2
100 × 65 4 × 2½	108.0 × 76.1 4.250 × 3.000		81 3.18	172 6.77	106.5 4.19	92 3.78	64.5 2.54	1/2*65-2
100 × 25 4 × 1	114.3 × 33.7 4.500 × 1.315		38 1.50	182 7.16	73 2.87	99 3.90	70 2.76	1/2*65-2
100 × 32 4 × 1¼	114.3 × 42.4 4.500 × 1.660		46 1.81	182 7.16	82 3.22	99 3.90	70 2.76	1/2*65-2
100 × 40 4 × 1½	114.3 × 48.3 4.500 × 1.900		53 2.08	182 7.16	87 3.42	99 3.90	70 2.76	1/2*65-2
100 × 50 4 × 2	114.3 × 60.3 4.500 × 2.375	61 2.40	182 7.16	100 3.93	99 3.90	70 2.76	1/2*65-2	
100 × 65 4 × 2½	114.3 × 73.0 4.500 × 2.875	81 3.18	182 7.16	118 4.64	99 3.90	70 2.76	1/2*65-2	
100 × 65 4 × 2½	114.3 × 76.1 4.500 × 3.000	81 3.18	182 7.16	118 4.64	99 3.90	70 2.76	1/2*65-2	
100 × 80 4 × 3	114.3 × 88.9 4.500 × 3.500	86 3.38	182 7.16	124 4.88	99 3.90	70 2.76	1/2*65-2	

注：产品尺寸可能会因技术原因有所改动，恕不另行通知，如有疑问请垂询金通管业技术部

The measurements of products maybe changed for the technical reason without responsibility note, please feel free to contact technical Dept.

Mechanical Tee Grooved outlet

沟槽式机械三通

XGQT3

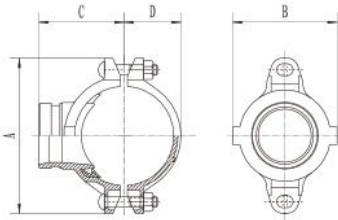

Nominal Size mm/in	Pipe OD. mm/in	Working Pressure psi/Mpa	Hole Dia. Mm/in +1.6,0/+0.063,0	Dimensions mm/in				Bolt Size
规格	管子基本尺寸	工作压力	开孔尺寸	A	B	C	D	螺栓规格
125 × 50 5 × 2	139.7 × 60.3 5.500 × 2.375	300 psi 2.07 Mpa	61 2.40	215 8.46	102 4.01	113 4.44	83 3.26	1/2*75-2
125 × 65 5 × 2½	139.7 × 76.1 5.500 × 3.000		81 3.18	215 8.46	119 4.68	113 4.44	83 3.26	1/2*75-2
125 × 80 5 × 3	139.7 × 88.9 5.500 × 3.500		86 3.38	215 8.46	134 5.27	113 4.44	83 3.26	1/2*75-2
125 × 100 5 × 4	139.7 × 114.3 5.500 × 4.500		114 4.48	215 8.46	158 6.22	115 4.52	83 3.26	1/2*75-2
125 × 50 5 × 2	141.3 × 60.3 5.563 × 2.375		61 2.40	215 8.46	102 4.01	114 4.48	83 3.26	1/2*75-2
125 × 65 5 × 2½	141.3 × 76.1 5.563 × 3.000		81 3.18	215 8.46	119 4.64	114 4.48	83 3.26	1/2*75-2
125 × 80 5 × 3	141.3 × 88.9 5.563 × 3.500		86 3.38	215 8.46	134 5.27	114 4.48	83 3.26	1/2*75-2
125 × 100 5 × 4	141.3 × 114.3 5.563 × 4.500		114 4.48	215 8.46	158 6.22	115 4.52	83 3.26	1/2*75-2
150 × 50 6 × 2	159.0 × 60.3 6.250 × 2.375		61 2.40	230 9.05	98 3.85	123 4.84	90 3.54	9/16*75-2
150 × 65 6 × 2½	159.0 × 76.1 6.250 × 3.000		81 3.18	230 9.05	121 4.76	123 4.84	90 3.54	9/16*75-2
150 × 80 6 × 3	159.0 × 88.9 6.250 × 3.500		86 3.38	230 9.05	134 5.27	123 4.84	90 3.54	9/16*75-2
150 × 100 6 × 4	159.0 × 108.0 6.250 × 4.250		114 4.48	230 9.05	155 6.10	123 4.84	90 3.54	9/16*75-2
150 × 100 6 × 4	159.0 × 114.3 6.250 × 4.500		114 4.48	230 9.05	155 6.10	123 4.84	90 3.54	9/16*75-2
150 × 50 6 × 2	165.1 × 60.3 6.500 × 2.375		61 2.40	240 9.44	102 4.01	126 4.96	96 3.77	9/16*75-2
150 × 65 6 × 2½	165.1 × 76.1 6.500 × 3.000		81 3.18	240 9.44	119 4.68	126 4.96	96 3.77	9/16*75-2
150 × 80 6 × 3	165.1 × 88.9 6.500 × 3.500		86 3.38	240 9.44	134 5.27	126 4.96	96 3.77	9/16*75-2
150 × 100 6 × 4	165.1 × 114.3 6.500 × 4.500		114 4.48	240 9.44	158 6.22	128 5.04	96 3.77	9/16*75-2
150 × 50 6 × 2	168.3 × 60.3 6.625 × 2.375		61 2.40	244 9.60	102 4.01	128 5.04	97 3.81	9/16*75-2
150 × 65 6 × 2½	168.3 × 73.0 6.625 × 2.875		81 3.18	244 9.60	119 4.68	128 5.04	97 3.81	9/16*75-2
150 × 65 6 × 2½	168.3 × 76.1 6.625 × 3.000		81 3.18	244 9.60	119 4.68	128 5.04	97 3.81	9/16*75-2
150 × 80 6 × 3	168.3 × 88.9 6.625 × 3.500	86 3.38	244 9.60	134 5.27	128 5.04	97 3.81	9/16*75-2	
150 × 100 6 × 4	168.3 × 114.3 6.625 × 4.500	114 4.48	244 9.60	158 6.22	130 5.11	97 3.81	9/16*75-2	
200 × 50 8 × 2	219.1 × 60.3 8.625 × 2.375	61 2.40	308 12.12	102 4.01	153 6.02	124 4.88	5/8*95-2	
200 × 65 8 × 2½	219.1 × 76.1 8.625 × 3.000	81 3.18	308 12.12	119 4.68	153 6.02	124 4.88	5/8*95-2	
200 × 80 8 × 3	219.1 × 88.9 8.625 × 3.500	86 3.38	308 12.12	134 5.27	153 6.02	124 4.88	5/8*95-2	
200 × 100 8 × 4	219.1 × 114.3 8.625 × 4.500	114 4.48	308 12.12	158 6.22	155 6.10	124 4.88	5/8*95-2	

注：产品尺寸可能会因技术原因有所改动，恕不另行通知，如有疑问请垂询金通管业技术部

The measurements of products maybe changed for the technical reason without responsibility note, please feel free to contact technical Dept.



Mechanical Tee Threaded outlet

螺纹式机械三通

XGQT3S

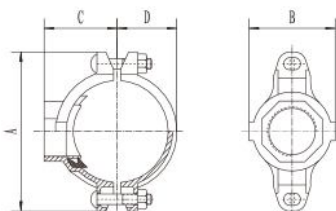

Nominal Size mm/in	Pipe OD. mm/in	Working Pressure psi/Mpa	Hole Dia. Mm/in +1.6,0/+0.063,0	Dimensions mm/in				Bolt Size
				A	B	C	D	
规格	管子基本尺寸	工作压力	开孔尺寸	A	B	C	D	螺栓规格
50×15 2×½	60.3×21.3 2.375×0.825	300 psi 2.07 Mpa	30 1.18	116 4.57	68 2.68	58 2.28	40 1.57	3/8*55-2
50×20 2×¾	60.3×26.9 2.375×1.050		30 1.18	116 4.57	68 2.68	58 2.28	39 1.53	3/8*55-2
50×25 2×1	60.3×33.7 2.375×1.315		38 1.50	118 4.64	71 2.80	58 2.36	40 1.57	3/8*55-2
50×32 2×1¼	60.3×42.4 2.375×1.660		46 1.81	118 4.64	75 2.95	60 2.56	40 1.57	3/8*55-2
50×40 2×1½	60.3×48.3 2.375×1.900		46 1.81	118 4.64	75 2.95	63 2.56	40 1.57	3/8*55-2
65×15 2½×½	73.0×21.3 2.875×0.825		30 1.18	144 5.66	71 2.80	66 2.72	49 1.93	3/8*55-2
65×20 2½×¾	73.0×26.9 2.875×1.050		30 1.18	144 5.66	71 2.80	66 2.72	49 1.93	3/8*55-2
65×25 2½×1	73.0×33.7 2.875×1.315		38 1.50	133 5.23	72 2.83	67 2.72	47 1.85	3/8*55-2
65×32 2½×1¼	73.0×42.4 2.875×1.660		46 1.81	133 5.23	81 3.18	69 2.87	47 1.85	3/8*55-2
65×40 2½×1½	73.0×48.3 2.875×1.900		53 2.08	133 5.23	86 3.38	69 2.87	47 1.85	3/8*55-2
65×15 2½×½	76.1×21.3 3.000×0.825		30 1.18	137 5.39	71 2.80	68 2.72	49.5 1.95	3/8*55-2
65×20 2½×¾	76.1×26.9 3.000×1.050		30 1.18	137 5.39	71 2.80	68 2.72	49.5 1.95	3/8*55-2
65×25 2½×1	76.1×33.7 3.000×1.315		38 1.50	136 5.35	72 2.83	69 2.72	49 1.93	3/8*55-2
65×32 2½×1¼	76.1×42.4 3.000×1.660		46 1.81	136 5.35	81 3.18	71 2.72	49 1.93	3/8*55-2
65×40 2½×1½	76.1×48.3 3.000×1.900		53 2.08	136 5.35	86 3.38	71 2.72	49 1.93	3/8*55-2
80×15 3×½	88.9×21.3 3.500×0.825		30 1.18	152 5.98	72.5 2.85	74 3.15	56.5 2.22	3/8*55-2
80×20 3×¾	88.9×26.9 3.500×1.050		30 1.18	152 5.98	72.5 2.85	74 3.15	56.5 2.22	3/8*55-2
80×25 3×1	88.9×33.7 3.500×1.315		38 1.50	150 5.98	73 2.87	75 3.15	56 2.20	3/8*55-2
80×32 3×1¼	88.9×42.4 3.500×1.660		46 1.81	150 5.98	82 3.22	77 3.15	56 2.20	3/8*55-2
80×40 3×1½	88.9×48.3 3.500×1.900		53 2.08	150 5.90	87 3.42	77 3.15	56 2.20	3/8*55-2

Mechanical Tee Threaded outlet

螺纹式机械三通

XGQT3S

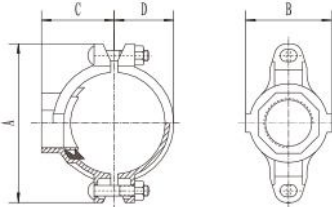

Nominal Size mm/in	Pipe OD. mm/in	Working Pressure psi/Mpa	Hole Dia. Mm/in +1.6,0/+0.063,0	Dimensions mm/in				Bolt Size
规格	管子基本尺寸	工作压力	开孔尺寸	A	B	C	D	螺栓规格
80 × 50 3 × 2	88.9 × 60.3 3.500 × 2.375	300 psi 2.07 Mpa	61 2.40	150 5.90	100 3.93	81 3.15	56 2.20	3/8*55-2
100 × 25 4 × 1	108.0 × 33.7 4.250 × 1.315		38 1.50	172 6.77	78.5 3.09	87 3.43	64.5 2.54	1/2*65-2
100 × 32 4 × 1¼	108.0 × 42.4 4.250 × 1.660		46 1.81	172 6.77	89 3.50	87 3.43	64.5 2.54	1/2*65-2
100 × 40 4 × 1½	108.0 × 48.3 4.250 × 1.900		53 2.08	172 6.77	89 3.50	87 3.43	64.5 2.54	1/2*65-2
100 × 50 4 × 2	108.0 × 60.3 4.250 × 2.375		61 2.40	172 6.77	106.5 4.19	92 3.62	64.5 2.54	1/2*65-2
100 × 65 4 × 2½	108.0 × 76.1 4.250 × 3.000		81 3.18	172 6.77	106.5 4.19	96 3.78	64.5 2.54	1/2*65-2
100 × 80 4 × 3	108.0 × 88.9 4.250 × 3.500		86 3.38	172 6.77	106.5 4.19	100 3.94	64.5 2.54	1/2*65-2
100 × 25 4 × 1	114.3 × 33.7 4.500 × 1.315		38 1.50	182 7.16	73 2.87	89 3.66	70 2.76	1/2*65-2
100 × 32 4 × 1¼	114.3 × 42.4 4.500 × 1.660		46 1.81	182 7.16	82 3.22	90 3.74	70 2.76	1/2*65-2
100 × 40 4 × 1½	114.3 × 48.3 4.500 × 1.900		53 2.08	182 7.16	87 3.42	90 3.82	70 2.76	1/2*65-2
100 × 50 4 × 2	114.3 × 60.3 4.500 × 2.375		61 2.40	182 7.16	100 3.93	95 3.62	70 2.76	1/2*65-2
100 × 65 4 × 2½	114.3 × 73.0 4.500 × 2.875		81 3.18	182 7.16	118 4.64	94 4.02	70 2.76	1/2*65-2
100 × 65 4 × 2½	114.3 × 76.1 4.500 × 3.000		81 3.18	182 7.16	118 4.64	94 4.02	70 2.76	1/2*65-2
100 × 80 4 × 3	114.3 × 88.9 4.500 × 3.500		86 3.38	182 7.16	124 4.88	100 4.02	70 2.76	1/2*65-2
125 × 25 5 × 1	133.0 × 33.7 5.250 × 1.315		38 1.50	208 8.18	74 2.91	100 4.13	79 3.11	1/2*75-2
125 × 32 5 × 1¼	133.0 × 42.4 5.250 × 1.660		46 1.81	208 8.18	83 3.26	101 4.13	79 3.11	1/2*75-2
125 × 40 5 × 1½	133.0 × 48.3 5.250 × 1.900		53 2.08	208 8.18	88 3.46	101 4.13	79 3.11	1/2*75-2
125 × 50 5 × 2	133.0 × 60.3 5.250 × 2.375		61 2.40	208 8.18	102 4.01	105 4.33	79 3.11	1/2*75-2
125 × 65 5 × 2½	133.0 × 76.1 5.250 × 3.000		81 3.18	208 8.18	119 4.68	103 4.53	79 3.11	1/2*75-2
125 × 80 5 × 3	133.0 × 88.9 5.250 × 3.500		86 3.38	208 8.18	134 5.27	110 4.65	79 3.11	1/2*75-2

注：产品尺寸可能会因技术原因有所改动，恕不另行通知，如有疑问请垂询金通管业技术部



Mechanical Tee Threaded outlet

螺纹式机械三通
XGQT3S

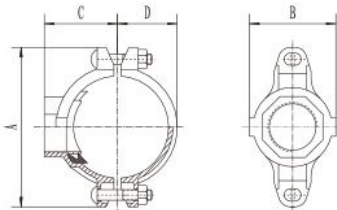

Nominal Size mm/in	Pipe OD. mm/in	Working Pressure psi/Mpa	Hole Dia. Mm/in +1.6,0/+0.063,0	Dimensions mm/in				Bolt Size
规格	管子基本尺寸	工作压力	开孔尺寸	A	B	C	D	螺栓规格
125×25 5×1	139.7×33.7 5.500×1.315	300 psi 2.07 Mpa	38 1.50	215 8.46	74 2.91	103 4.33	83 3.26	1/2*75-2
125×32 5×1¼	139.7×42.4 5.500×1.660		46 1.81	215 8.46	83 3.26	104 4.41	83 3.26	1/2*75-2
125×40 5×1½	139.7×48.3 5.500×1.900		53 2.08	215 8.46	88 3.46	104 4.41	83 3.26	1/2*75-2
125×50 5×2	139.7×60.3 5.500×2.375		61 2.40	215 8.46	102 4.01	108 4.53	83 3.26	1/2*75-2
125×65 5×2½	139.7×76.1 5.500×3.000		81 3.18	215 8.46	119 4.68	108 4.53	83 3.26	1/2*75-2
125×80 5×3	139.7×88.9 5.500×3.500		86 3.38	215 8.46	134 5.27	113 4.72	83 3.26	1/2*75-2
125×25 5×1	141.3×33.7 5.563×1.315		38 1.50	215 8.46	74 2.91	103 4.33	84 3.31	1/2*75-2
125×32 5×1¼	141.3×42.4 5.563×1.660		46 1.81	215 8.46	83 3.26	104 4.41	84 3.31	1/2*75-2
125×40 5×1½	141.3×48.3 5.563×1.900		53 2.08	215 8.46	88 3.46	104 4.41	84 3.31	1/2*75-2
125×50 5×2	141.3×60.3 5.563×2.375		61 2.40	215 8.46	102 4.01	108 4.53	83 3.26	1/2*75-2
125×65 5×2½	141.3×76.1 5.563×3.000		81 3.18	215 8.46	119 4.68	108 4.53	83 3.26	1/2*75-2
125×80 5×3	141.3×88.9 5.563×3.500		86 3.38	215 8.46	134 5.27	114 4.72	83 3.26	1/2*75-2
150×25 6×1	159.0×33.7 6.250×1.315		38 1.50	244 9.60	78 3.07	116 4.57	94 3.70	9/16*75-2
150×32 6×1¼	159.0×42.4 6.250×1.660		46 1.81	244 9.60	93 3.66	118 4.65	94 3.70	9/16*75-2
150×40 6×1½	159.0×48.3 6.250×1.900		53 2.08	244 9.60	93 3.66	118 4.65	94 3.70	9/16*75-2
150×50 6×2	159.0×60.3 6.250×2.375		61 2.40	230 9.05	98 3.85	115 4.53	90 3.54	9/16*75-2
150×65 6×2½	159.0×76.1 6.250×3.000		81 3.18	230 9.05	121 4.76	125 4.92	90 3.54	9/16*75-2
150×80 6×3	159.0×88.9 6.250×3.500		86 3.38	230 9.05	134 5.27	125 4.92	90 3.54	9/16*75-2
150×100 6×4	159.0×114.3 6.250×4.500		114 4.48	230 9.05	155 6.10	130 5.12	90 3.54	9/16*75-2
150×25 6×1	165.1×33.7 6.500×1.315		38 1.50	240 9.44	74 2.91	117 4.65	96 3.77	9/16*75-2
150×32 6×1¼	165.1×42.4 6.500×1.660		46 1.81	240 9.44	83 3.26	118 4.65	97.5 3.84	9/16*75-2
150×40 6×1½	165.1×48.3 6.500×1.900		53 2.08	240 9.44	88 3.46	118 4.65	97.5 3.84	9/16*75-2
150×50 6×2	165.1×60.3 6.500×2.375		61 2.40	240 9.44	102 4.01	120 5.43	96 3.77	9/16*75-2
150×65 6×2½	165.1×76.1 6.500×3.000		81 3.18	240 9.44	119 4.68	121 5.43	96 3.77	9/16*75-2
150×80 6×3	165.1×88.9 6.500×3.500		86 3.38	240 9.44	134 5.27	126 5.43	96 3.77	9/16*75-2
150×100 6×4	165.1×114.3 6.500×4.500		114 4.48	240 9.44	158 6.22	132 5.32	96 3.77	9/16*75-2
150×25 6×1	168.3×33.7 6.625×1.315		38 1.50	244 9.60	74 2.91	119 5.12	97 3.81	9/16*75-2
150×32 6×1¼	168.3×42.4 6.625×1.660		46 1.81	244 9.60	83 3.26	120 5.12	98.5 3.88	9/16*75-2
150×40 6×1½	168.3×48.3 6.625×1.900		53 2.08	244 9.60	88 3.46	120 4.80	98.5 3.88	9/16*75-2
150×50 6×2	168.3×60.3 6.625×2.375		61 2.40	244 9.60	102 4.01	122 5.20	97 3.81	9/16*75-2
150×65 6×2½	168.3×73.0 6.625×2.875		81 3.18	244 9.60	119 4.68	123 5.20	97 3.81	9/16*75-2
150×65 6×2½	168.3×76.1 6.625×3.000		81 3.18	244 9.60	119 4.68	123 5.20	97 3.81	9/16*75-2
150×80 6×3	168.3×88.9 6.625×3.500		86 3.38	244 9.60	134 5.27	128 5.51	97 3.81	9/16*75-2
150×100 6×4	168.3×114.3 6.625×4.500		114 4.48	244 9.60	158 6.22	134 5.51	97 3.81	9/16*75-2
200×25 8×1	219.1×33.7 8.625×1.315		38 1.50	308 12.12	74 2.91	145 5.91	124 4.88	5/8*95-2
200×32 8×1¼	219.1×42.4 8.625×1.660		46 1.81	308 12.12	83 3.26	146 5.91	124 4.88	5/8*95-2
200×40 8×1½	219.1×48.3 8.625×1.900		53 2.08	308 12.12	88 3.46	146 5.91	124 4.88	5/8*95-2
200×50 8×2	219.1×60.3 8.625×2.375		61 2.40	308 12.12	102 4.01	149 6.30	124 4.88	5/8*95-2
200×65 8×2½	219.1×76.1 8.625×3.000		81 3.18	308 12.12	119 4.68	149 6.24	124 4.88	5/8*95-2
200×80 8×3	219.1×88.9 8.625×3.500		86 3.38	308 12.12	134 5.27	154 6.30	124 4.88	5/8*95-2
200×100 8×4	219.1×114.3 8.625×4.500	114 4.48	308 12.12	158 6.22	159 6.30	124 4.88	5/8*95-2	

U-Bolt Mechanical Tee U型栓机械三通 XGQT3US

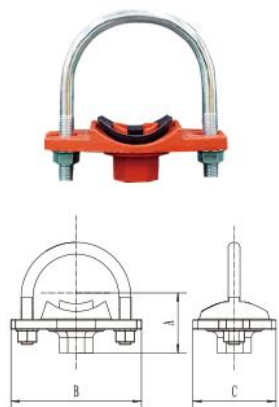

Nominal Size mm/in	Pipe OD. mm/in	Working Pressure psi/Mpa	Hole Dia. Mm/in +1.6,0/+0.063,0	Dimensions mm/in			Bolt Size
				A	B	C	
规格	管子基本尺寸	工作压力	开孔尺寸	A	B	C	螺栓规格
25×15 1×½	33.7*21.3 1.315*0.825	300 psi 2.07 Mpa	24 0.94	43 1.69	82 3.22	41 1.61	3/8*60-2
25×20 1×¾	33.7*26.9 1.315*1.050		24 0.94	45 1.77	82 3.22	41 1.61	3/8*60-2
32×15 1¼×½	42.4*21.3 1.660*0.825		30 1.18	47 1.85	88 3.46	52 2.04	3/8*76-2
32×20 1¼×¾	42.4*26.9 1.660*1.050		30 1.18	49 1.93	88 3.46	52 2.04	3/8*76-2
32×25 1¼×1	42.4*33.7 1.660*1.315		30 1.18	51 2.00	88 3.46	52 2.04	3/8*76-2
40×15 1½×½	48.3*21.3 1.900*0.825		30 1.18	50 1.96	88 3.46	52 2.04	3/8*76-2
40×20 1½×¾	48.3*26.9 1.900*1.050		30 1.18	52 2.04	88 3.46	52 2.04	3/8*76-2
40×25 1½×1	48.3*33.7 1.900*1.315		30 1.18	54 2.12	88 3.46	52 2.04	3/8*76-2
50×15 2×½	60.3*21.3 2.375*0.825		30 1.18	56 2.20	102 4.01	52 2.04	3/8*92-2
50×20 2×¾	60.3*26.9 2.375*1.050		30 1.18	58 2.28	102 4.01	52 2.04	3/8*92-2
50×25 2×1	60.3*33.7 2.375*1.315		38 1.50	60 2.36	102 4.01	61 2.40	3/8*92-2
65×15 2½×½	73.0*21.3 2.875*0.825		30 1.18	63 2.48	112 4.40	52 2.04	3/8*108-2
65×20 2½×¾	73.0*26.9 2.875*1.050		30 1.18	65 2.55	112 4.40	52 2.04	3/8*108-2
65×25 2½×1	73.0*33.7 2.875*1.315		38 1.50	67 2.63	112 4.40	61 2.40	3/8*108-2
65×15 2½×½	76.1*21.3 3.000*0.825		30 1.18	64 2.51	112 4.40	52 2.04	3/8*108-2
65×20 2½×¾	76.1*26.9 3.000*1.050		30 1.18	66 2.59	112 4.40	52 2.04	3/8*108-2
65×25 2½×1	76.1*33.7 3.000*1.315		38 1.50	68 2.67	112 4.40	61 2.40	3/8*108-2

注：产品尺寸可能会因技术原因有所改动，恕不另行通知，如有疑问请垂询金通管业技术部

The measurements of products maybe changed for the technical reason without responsibility note, please feel free to contact technical Dept.



Grooved Flange ANSI Class 150 沟槽法兰

Grooved Flange

沟槽法兰 XGQT09

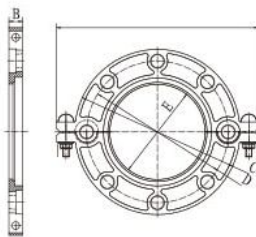

Nominal Size mm/in	Pipe OD. mm/in	Working Pressure psi/Mpa	Dimensions mm/in					Bolt/Size	
			A mm/in	B mm/in	C mm/in	D mm/in	E mm/in	No.-Size mm	
规格	管子基本尺寸	工作压力	尺寸					螺栓	
50 2	60.3 2.375	300 psi 2.07 Mpa	206 8.11	19 0.74	152 5.98	121 4.76	57.5 2.26	M10*50-2	5/8-4
65 2½	73 2.875		230 9.05	19 0.74	178 7.00	140 5.51	69.0 2.71	M10*50-2	5/8-4
80 3	88.9 3.5		244 9.60	19 0.74	191 7.52	152 5.98	85.0 3.34	M10*50-2	5/8-4
100 4	114.3 4.5		280 11.02	19 0.74	229 9.00	191 7.52	110.5 4.35	M12*55-2	5/8-8
125 5	141.3 5.563		322 12.67	22 0.86	250 9.84	216 8.50	137.0 5.39	M12*65-2	3/4-8
150 6	168.3 6.625		346 13.62	22 0.86	285 11.22	241.5 9.50	164.0 6.45	M12*65-2	3/4-8
200 8	219.1 8.625		410 16.14	24 0.94	340.0 13.38	298.5 11.75	214.0 8.42	3/8*70-2	3/4-8
250 10	273 10.75		478.0 18.81	25 0.98	405.6 15.97	362.0 14.25	268.0 10.55	3/8*70-2	7/8-12

Grooved Flange PN 16 沟槽法兰

Nominal Size mm/in	Pipe OD. mm/in	Working Pressure psi/Mpa	Dimensions mm/in					Bolt/Size	
			A mm/in	B mm/in	C mm/in	D mm/in	E mm/in	No.-Size mm	
规格	管子基本尺寸	工作压力	尺寸					螺栓	
50 2	60.3 2.375	232psi 1.6Mpa	215 8.46	24 0.95	160 6.29	125 4.92	57.5 2.26	M10*50-2	4-M16
65 2½	73 2.875		240 9.44	24 0.95	176 6.92	145 5.71	69.8 2.74	M10*50-2	4-M16
65 2½	76.1 3		240 9.44	24 0.95	176 6.92	145 5.71	72.7 2.86	M10*50-2	4-M16
80 3	88.9 3.5		250 9.84	24 0.95	184 7.24	160 6.30	85.5 3.37	M10*50-2	8-M16
100 4	108 4.25		266 10.47	24 0.95	218 8.58	180 7.09	104.5 4.11	M12*55-2	8-M16
100 4	114.3 4.5		266 10.47	24 0.95	218 8.58	180 7.09	110.5 4.35	M12*55-2	8-M16
125 5	133 5.25		300 11.81	24 0.95	247 9.72	210 8.27	129.2 5.08	M12*65-2	8-M16
125 5	139.7 5.5		300 11.81	24 0.95	247 9.72	210 8.27	135.5 5.33	M12*65-2	8-M16
125 5	141.3 5.563		300 11.81	24 0.95	247 9.72	210 8.27	137.4 5.41	M12*65-2	8-M16
150 6	159 6.25		336 13.22	24 0.95	282 11.10	240 9.45	154.5 6.08	M12*65-2	8-M20
150 6	165.1 6.5		336 13.22	24 0.95	282 11.10	240 9.45	163.5 6.43	M12*65-2	8-M20
150 6	168.3 6.625		336 13.22	24 0.95	282 11.10	240 9.45	163.5 6.43	M12*65-2	8-M20
200 8	219.1 8.625		395 15.55	27 1.06	335 13.18	295 11.61	214.5 8.44	3/8*70-2	12-M20
250 10	273 10.75		470 18.50	27 1.06	404 15.90	355 13.97	267 10.51	3/8*70-2	12-M24

90° Elbow

90° 弯头

XGQT01

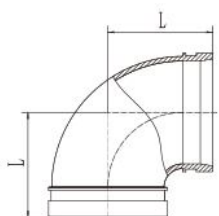

45° Elbow

45° 弯头

XGQT02



Nominal Size mm/in	Pipe OD. mm/in	Working Pressure psi/Mpa	Dimensions L mm/in
规格	管子基本尺寸	工作压力	尺寸
25	33.7	300 psi 2.07 Mpa	57
1	1.327		2.24
32	42.4		60
1¼	1.669		2.36
40	48.3		60
1½	1.9		2.36
50	60.3		70
2	2.375		2.75
65	73		76
2½	2.875		3.00
65	76.1		76
2½	3		3.00
80	88.9		86
3	3.5		3.38
100	108		101
4	4.25		3.98
100	114.3		101
4	4.5		3.98
125	133		121
5	5.25		4.76
125	139.7	121	
5	5.5	4.76	
125	141.3	121	
5	5.563	4.76	
150	159	140	
6	6.25	5.51	
150	165.1	140	
6	6.5	5.51	
150	168.3	140	
6	6.625	5.51	
200	219.1	175	
8	8.625	6.88	
250	273	188.5	
10	10.75	7.42	
300	323.9	222.5	
12	12.750	8.76	

Nominal Size mm/in	Pipe OD. mm/in	Working Pressure psi/Mpa	Dimensions L mm/in
规格	管子基本尺寸	工作压力	尺寸
25	33.7	300 psi 2.07 Mpa	45
1	1.327		1.77
32	42.4		45
1¼	1.669		1.77
40	48.3		45
1½	1.9		1.77
50	60.3		51
2	2.375		2.00
65	73		57
2½	2.875		2.24
65	76.1		57
2½	3		2.24
80	88.9		64
3	3.5		2.51
100	108		76
4	4.25		3.00
100	114.3		76
4	4.5		3.00
125	133		82.5
5	5.25		3.24
125	139.7	82.5	
5	5.5	3.24	
125	141.3	82.5	
5	5.563	3.24	
150	159	89	
6	6.25	3.50	
150	165.1	89	
6	6.5	3.50	
150	168.3	89	
6	6.625	3.50	
200	219.1	108	
8	8.625	4.25	
250	273	120.5	
10	10.75	4.74	
300	323.9	133	
12	12.750	5.23	

注：产品尺寸可能会因技术原因有所改动，恕不另行通知，如有疑问请垂询金通管业技术部

The measurements of products maybe changed for the technical reason without responsibility note, please feel free to contact technical Dept.



22.5° Elbow
22.5° 弯头 XGQT021

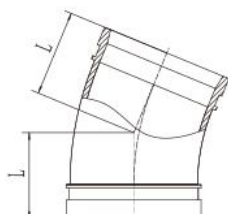

11.25° Elbow
11.25° 弯头 XGQT022

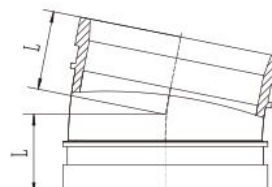

Nominal Size mm/in	Pipe OD. mm/in	Working Pressure psi/Mpa	Dimensions L mm/in
规格	管子基本尺寸	工作压力	尺寸
32 1¼	42.4 1.669	300 psi 2.07 Mpa	45 1.77
40 1½	48.3 1.9		45 1.77
50 2	60.3 2.375		48 1.88
65 2½	73 2.875		51 2.00
65 2½	76.1 3		51 2.00
80 3	88.9 3.5		57 2.24
100 4	108 4.25		73 2.87
100 4	114.3 4.5		73 2.87
125 5	133 5.25		73 2.87
125 5	139.7 5.5		73 2.87
150 6	159 6.25		89 3.50
150 6	165.1 6.5		89 3.50
150 6	168.3 6.625		89 3.50
200 8	219.1 8.625		98 3.85

Nominal Size mm/in	Pipe OD. mm/in	Working Pressure psi/Mpa	Dimensions L mm/in
规格	管子基本尺寸	工作压力	尺寸
50 2	60.3 2.375	300 psi 2.07 Mpa	35 1.37
65 2½	76.1 3		38 1.49
80 3	88.9 3.5		38 1.49
100 4	108 4.25		44 1.73
100 4	114.3 4.5		44 1.73
125 5	133 5.25		51 2.00
125 5	139.7 5.5		51 2.00
150 6	159 6.25		51 2.00
150 6	165.1 6.5		51 2.00
150 6	168.3 6.625		51 2.00
200 8	219.1 8.625		51 2.00

Tee
正三通
XGQT03

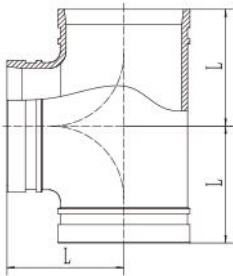

Nominal Size mm/in	Pipe OD. mm/in	Working Pressure psi/Mpa	Dimensions L mm/in
规格	管子基本尺寸	工作压力	尺寸
25 1	33.7 1.327	300 psi 2.07 Mpa	57 2.24
32 1¼	42.4 1.669		60 2.36
40 1½	48.3 1.9		60 2.36
50 2	60.3 2.375		70 2.75
65 2½	73 2.875		76 3.00
65 2½	76.1 3		76 3.00
80 3	88.9 3.5		86 3.38
100 4	108 4.25		101 3.98
100 4	114.3 4.5		101 3.98
125 5	133 5.25		121 4.76
125 5	139.7 5.5		121 4.76
125 5	141.3 5.563		121 4.76
150 6	159 6.25		140 5.51
150 6	165.1 6.5		140 5.51
150 6	168.3 6.625		140 5.51
200 8	219.1 8.625		175 6.88
250 10	273 10.75		215 8.46
300 12	323.9 12.750		245 9.64

注：产品尺寸可能会因技术原因有所改动，恕不另行通知，如有疑问请垂询金通管业技术部

The measurements of products maybe changed for the technical reason without responsibility note, please feel free to contact technical Dept.

Grooved Reducing Tee
沟槽式异径三通
XGQT04

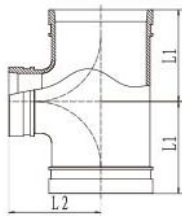

Nominal Size mm/in	Pipe OD. mm/in	Working Pressure psi/Mpa	Dimensions L1 mm/in	Dimensions L2 mm/in
规格	管子基本尺寸	工作压力	尺寸	尺寸
50×25 2×1	60.3×33.7 2.375×1.315	300 psi 2.07 Mpa	70 2.75	70 2.75
50×32 2×1¼	60.3×42.4 2.375×1.660		70 2.75	70 2.75
50×40 2×1½	60.3×48.3 2.375×1.900		70 2.75	70 2.75
65×32 2½×1¼	73.0×42.4 2.875×1.660		76 3.00	76 3.00
65×40 2½×1½	73.0×48.3 2.875×1.900		76 3.00	76 3.00
65×50 2½×2	73.0×60.3 2.875×2.375		76 3.00	76 3.00
65×32 2½×1¼	76.1×42.4 3.000×1.660		76 3.00	76 3.00
65×40 2½×1½	76.1×48.3 3.000×1.900		76 3.00	76 3.00
65×50 2½×2	76.1×60.3 3.000×2.375		76 3.00	76 3.00
80×40 3×1½	88.9×48.3 3.500×1.900		86 3.38	86 3.38
80×50 3×2	88.9×60.3 3.500×2.375		86 3.38	86 3.38
80×65 3×2½	88.9×76.1 3.500×3.000		86 3.38	86 3.38
100×65 4×2½	108.0×76.1 4.250×3.000		101 3.98	101 3.98
100×80 4×3	108.0×88.9 4.250×3.500		101 3.98	101 3.98
100×50 4×2	114.3×60.3 4.500×2.375		101 3.98	101 3.98
100×65 4×2½	114.3×76.1 4.500×3.000		101 3.98	101 3.98
100×80 4×3	114.3×88.9 4.500×3.500		101 3.98	101 3.98
125×50 5×2	133.0×60.3 5.250×2.375		121 4.76	121 4.76
125×65 5×2½	133.0×76.1 5.250×3.000		121 4.76	121 4.76
125×100 5×4	133.0×108.0 5.250×4.250		121 4.76	121 4.76
125×100 5×4	133.0×114.3 5.250×4.500	121 4.76	121 4.76	
125×50 5×2	139.7×60.3 5.500×2.375	121 4.76	121 4.76	
125×65 5×2½	139.7×76.1 5.500×3.000	121 4.76	121 4.76	
125×80 5×3	139.7×88.9 5.500×3.500	121 4.76	121 4.76	
125×100 5×4	139.7×114.3 5.500×4.500	121 4.76	121 4.76	
125×50 5×2	141.3×60.3 5.563×2.375	121 4.76	121 4.76	
125×65 5×2½	141.3×73.0 5.563×2.875	121 4.76	121 4.76	

Grooved Reducing Tee
沟槽式异径三通
XGQT04

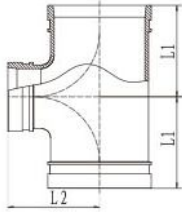

Nominal Size mm/in	Pipe OD. mm/in	Working Pressure psi/Mpa	Dimensions L1 mm/in	Dimensions L2 mm/in
规格	管子基本尺寸	工作压力	尺寸	尺寸
125×65 5×2½	141.3×76.1 5.563×3.000	300 psi 2.07 Mpa	121 4.76	121 4.76
125×80 5×3	141.3×88.9 5.563×3.500		121 4.76	121 4.76
125×100 5×4	141.3×114.3 5.563×4.500		121 4.76	121 4.76
150×65 6×2½	159.0×76.1 6.250×3.000		140 5.50	140 5.50
150×80 6×3	159.0×88.9 6.250×3.500		140 5.50	140 5.50
150×100 6×4	159.0×108.0 6.250×4.250		140 5.50	140 5.50
150×100 6×4	159.0×114.3 6.250×4.500		140 5.50	140 5.50
150×50 6×2	165.1×60.3 6.500×2.375		140 5.50	140 5.50
150×65 6×2½	165.1×76.1 6.500×3.000		140 5.50	140 5.50
150×80 6×3	165.1×88.9 6.500×3.500		140 5.50	140 5.50
150×100 6×4	165.1×114.3 6.500×4.500		140 5.50	140 5.50
150×125 6×5	165.1×139.7 6.500×5.500		140 5.50	140 5.50
150×50 6×2	168.3×60.3 6.625×2.375		140 5.50	140 5.50
150×65 6×2½	168.3×76.1 6.625×3.000		140 5.50	140 5.50
150×80 6×3	168.3×88.9 6.625×3.500		140 5.50	140 5.50
200×65 8×2½	219.1×76.1 8.625×3.000		175 6.88	175 6.88
200×80 8×3	219.1×88.9 8.625×3.500		175 6.88	175 6.88
200×100 8×4	219.1×108.0 8.625×4.250		175 6.88	175 6.88
200×100 8×4	219.1×114.3 8.625×4.500		175 6.88	175 6.88
200×125 8×5	219.1×139.7 8.625×5.500		175 6.88	175 6.88
200×150 8×6	219.1×159.0 8.625×6.250		175 6.88	175 6.88
200×150 8×6	219.1×165.1 8.625×6.500		175 6.88	175 6.88
200×150 8×6	219.1×168.3 8.625×6.625		175 6.88	175 6.88
250×100 10×4	273.0×114.3 10.750×4.500		215 8.46	215 8.46
250×125 10×5	273.0×139.7 10.750×5.500		215 8.46	215 8.46
250×150 10×6	273.0×165.1 10.750×6.500		215 8.46	215 8.46

注：产品尺寸可能会因技术原因有所改动，恕不另行通知，如有疑问请垂询金通管业技术部

The measurements of products maybe changed for the technical reason without responsibility note, please feel free to contact technical Dept.

Threaded Reducing Tee
 螺纹式异径三通
 XGQT04S

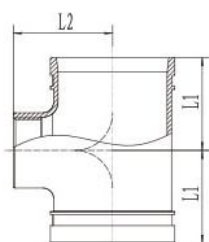

Nominal Size mm/in	Pipe OD. mm/in	Working Pressure psi/Mpa	Dimensions L1 mm/in	Dimensions L2 mm/in
规格	管子基本尺寸	工作压力	尺寸	尺寸
40×25 1½×1	48.3×33.7 1.900×1.315	300 psi 2.07 Mpa	60 2.36	60 2.36
40×32 1½×1¼	48.3×42.4 1.900×1.660		60 2.36	60 2.36
50×25 2×1	60.3×33.7 2.375×1.315		70 2.75	70 2.75
50×32 2×1¼	60.3×42.4 2.375×1.660		70 2.75	70 2.75
50×40 2×1½	60.3×48.3 2.375×1.900		70 2.75	70 2.75
65×25 2½×1	73.0×33.7 2.875×1.315		76 3.00	76 3.00
65×32 2½×1¼	73.0×42.4 2.875×1.660		76 3.00	76 3.00
65×40 2½×1½	73.0×48.3 2.875×1.900		76 3.00	76 3.00
65×50 2½×2	73.0×60.3 2.875×2.375		76 3.00	76 3.00
65×25 2½×1	76.1×33.7 3.000×1.315		76 3.00	76 3.00
65×32 2½×1¼	76.1×42.4 3.000×1.660		76 3.00	76 3.00
65×40 2½×1½	76.1×48.3 3.000×1.900		76 3.00	76 3.00
65×50 2½×2	76.1×60.3 3.000×2.375		76 3.00	76 3.00
80×25 3×1	88.9×33.7 3.500×1.315		86 3.38	86 3.38
80×32 3×1¼	88.9×42.4 3.500×1.660		86 3.38	86 3.38
80×40 3×1½	88.9×48.3 3.500×1.900		86 3.38	86 3.38
80×50 3×2	88.9×60.3 3.500×2.375		86 3.38	86 3.38
80×65 3×2½	88.9×76.1 3.500×3.000		86 3.38	86 3.38
100×65 4×2½	108.0×76.1 4.250×3.000		101 3.98	101 3.98
100×80 4×3	108.0×88.9 4.250×3.500		101 3.98	101 3.98
100×25 4×1	114.3×33.7 4.500×1.315		101 3.98	101 3.98
100×32 4×1¼	114.3×42.4 4.500×1.660		101 3.98	101 3.98
100×40 4×1½	114.3×48.3 4.500×1.900		101 3.98	101 3.98
100×50 4×2	114.3×60.3 4.500×2.375		101 3.98	101 3.98
100×65 4×2½	114.3×76.1 4.500×3.000		101 3.98	101 3.98
100×80 4×3	114.3×88.9 4.500×3.500		101 3.98	101 3.98
125×25 5×1	139.7×33.7 5.500×1.315		121 4.76	121 4.76

Threaded Reducing Tee
 螺纹式异径三通
 XGQT04S

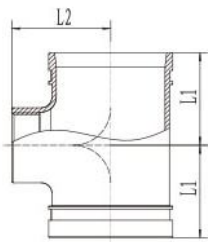

Nominal Size mm/in	Pipe OD. mm/in	Working Pressure psi/Mpa	Dimensions L1 mm/in	Dimensions L2 mm/in
规格	管子基本尺寸	工作压力	尺寸	尺寸
125×32 5×1¼	139.7×42.4 5.500×1.660	300 psi 2.07 Mpa	121 4.76	121 4.76
125×40 5×1½	139.7×48.3 5.500×1.900		121 4.76	121 4.76
125×50 5×2	139.7×60.3 5.500×2.375		121 4.76	121 4.76
125×65 5×2½	139.7×76.1 5.500×3.000		121 4.76	121 4.76
125×80 5×3	139.7×88.9 5.500×3.500		121 4.76	121 4.76
125×25 5×1	141.3×33.7 5.563×1.315		121 4.76	121 4.76
125×32 5×1¼	141.3×42.4 5.563×1.660		121 4.76	121 4.76
125×40 5×1½	141.3×48.3 5.563×1.900		121 4.76	121 4.76
125×50 5×2	141.3×60.3 5.563×2.375		121 4.76	121 4.76
125×65 5×2½	141.3×73.0 5.563×2.875		121 4.76	121 4.76
125×65 5×2½	141.3×76.1 5.563×3.000		121 4.76	121 4.76
150×65 6×2½	159.0×76.1 6.250×3.000		140 5.50	140 5.50
150×80 6×3	159.0×88.9 6.250×3.500		140 5.50	140 5.50
150×25 6×1	165.1×33.7 6.500×1.315		140 5.50	140 5.50
150×32 6×1¼	165.1×42.4 6.500×1.660		140 5.50	140 5.50
150×40 6×1½	165.1×48.3 6.500×1.900		140 5.50	140 5.50
150×50 6×2	165.1×60.3 6.500×2.375		140 5.50	140 5.50
150×65 6×2½	165.1×76.1 6.500×3.000		140 5.50	140 5.50
150×80 6×3	165.1×88.9 6.500×3.500		140 5.50	140 5.50
150×100 6×4	165.1×114.3 6.500×4.500		140 5.50	140 5.50
150×25 6×1	168.3×33.7 6.625×1.315		140 5.50	140 5.50
150×32 6×1¼	168.3×42.4 6.625×1.660		140 5.50	140 5.50
150×40 6×1½	168.3×48.3 6.625×1.900		140 5.50	140 5.50
150×50 6×2	168.3×60.3 6.625×2.375		140 5.50	140 5.50
200×50 8×2	219.1×60.3 8.625×2.375		175 6.88	175 6.88
200×65 8×2½	219.1×76.1 8.625×3.000		175 6.88	175 6.88
200×80 8×3	219.1×88.9 8.625×3.500		175 6.88	175 6.88

注：产品尺寸可能会因技术原因有所改动，恕不另行通知，如有疑问请垂询金通管业技术部

The measurements of products maybe changed for the technical reason without responsibility note, please feel free to contact technical Dept.

Cross
正四通
XGQT05

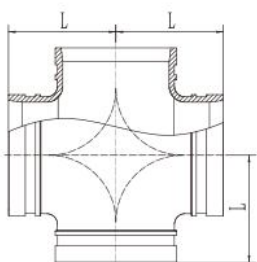

Nominal Size mm/in	Pipe OD. mm/in	Working Pressure psi/Mpa	Dimensions L mm/in
规格	管子基本尺寸	工作压力	尺寸
32 1¼	42.4 1.669	300 psi 2.07 Mpa	60 2.36
40 1½	48.3 1.9		60 2.36
50 2	60.3 2.375		70 2.75
65 2½	73.0 2.875		76 3.00
65 2½	76.1 3		76 3.00
80 3	88.9 3.5		86 3.38
100 4	108 4.25		101 3.98
100 4	114.3 4.5		101 3.98
125 5	133.0 5.25		121 4.76
125 5	139.7 5.5		121 4.76
125 5	141.3 5.563		121 4.76
150 6	159.0 6.25		140 5.51
150 6	165.1 6.5		140 5.51
150 6	168.3 6.625		140 5.51
200 8	219.1 8.625		175 6.88
250 10	273.0 10.75		215 8.46
300 12	323.9 12.750	245 9.64	

Grooved Reducing Cross
沟槽式异径四通
XGQT051

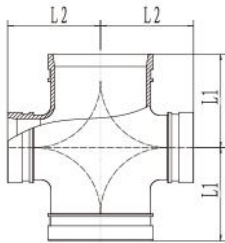

Nominal Size mm/in	Pipe OD. mm/in	Working Pressure psi/Mpa	Dimensions L1 mm/in	Dimensions L2 mm/in
规格	管子基本尺寸	工作压力	尺寸	尺寸
100×50 4×2	114.3×60.3 4.500×2.375	300 psi 2.07 Mpa	101 3.98	101 3.98
100×65 4×2½	114.3×76.1 4.500×3.000		101 3.98	101 3.98
100×80 4×3	114.3×88.9 5.563×3.500		101 3.98	101 3.98
125×100 5×4	139.7×114.3 5.500×4.500		121 4.76	121 4.76
150×100 6×4	165.1×114.3 6.500×4.500		140 5.50	140 5.50
150×50 6×2	168.3×60.3 6.625×2.375		140 5.50	140 5.50
150×65 6×2½	168.3×76.1 6.625×3.000		140 5.50	140 5.50
150×80 6×3	168.3×88.9 6.625×3.500		140 5.50	140 5.50
150×100 6×4	168.3×114.3 6.625×4.500		140 5.50	140 5.50

注：产品尺寸可能会因技术原因有所改动，恕不另行通知，如有疑问请垂询金通管业技术部

The measurements of products maybe changed for the technical reason without responsibility note, please feel free to contact technical Dept.

Threaded Reducing Cross
 螺纹式异径四通
 XGQT051S

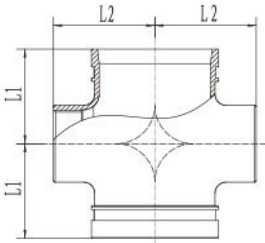

Nominal Size mm/in	Pipe OD. mm/in	Working Pressure psi/Mpa	Dimensions L1 mm/in	Dimensions L2 mm/in
规格	管子基本尺寸	工作压力	尺寸	尺寸
100×25 4×1	114.3×33.7 4.500×1.315	300 psi 2.07 Mpa	101 3.98	101 3.98
100×32 4×1¼	114.3×42.4 4.500×1.660		101 3.98	101 3.98
100×40 4×1½	114.3×48.3 4.500×1.900		101 3.98	101 3.98
100×50 4×2	114.3×60.3 4.500×2.375		101 3.98	101 3.98
100×65 4×2½	114.3×76.1 4.500×3.000		101 3.98	101 3.98
100×80 4×3	114.3×88.9 4.500×3.500		101 3.98	101 3.98
125×32 5×1¼	139.7×42.4 5.500×1.660		121 4.76	121 4.76
125×40 5×1½	139.7×48.3 5.500×1.900		121 4.76	121 4.76
125×50 5×2	139.7×60.3 5.500×2.375		121 4.76	121 4.76
125×65 5×2½	139.7×76.1 5.500×3.000		121 4.76	121 4.76
125×80 5×3	139.7×88.9 5.500×3.500		121 4.76	121 4.76
150×25 6×1	165.1×33.7 6.500×1.315		140 5.50	140 5.50
150×32 6×1¼	165.1×42.4 6.500×1.660		140 5.50	140 5.50
150×40 6×1½	165.1×48.3 6.500×1.900		140 5.50	140 5.50
150×50 6×2	165.1×60.3 6.500×2.375		140 5.50	140 5.50
150×65 6×2½	165.1×76.1 6.500×3.000		140 5.50	140 5.50
150×80 6×3	165.1×88.9 6.500×3.500	140 5.50	140 5.50	

Cap
盲片
XGQT06

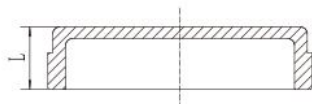

Nominal Size mm/in	Pipe OD. mm/in	Working Pressure psi/Mpa	Dimensions L mm/in
规格	管子基本尺寸	工作压力	尺寸
25 1	33.7 1.327	300 psi 2.07 Mpa	25 0.98
32 1¼	42.4 1.669		25 0.98
40 1½	48.3 1.9		25 0.98
50 2	60.3 2.375		25 0.98
65 2½	73 2.875		25 0.98
65 2½	76.1 3		25 0.98
80 3	88.9 3.5		26 10.2
100 4	108 4.25		26 10.2
100 4	114.3 4.5		26 10.2
125 5	133 5.25		26 10.2
125 5	139.7 5.5		26 10.2
125 5	141.3 5.563		26 10.2
150 6	159 6.25		26 10.2
150 6	165.1 6.5		26 10.2
150 6	168.3 6.625		26 10.2
200 8	219.1 8.625		30 1.18
250 10	273 10.75		32 1.25
300 12	323.9 12.750		32 1.25

注：产品尺寸可能会因技术原因有所改动，恕不另行通知，如有疑问请垂询金通管业技术部

The measurements of products maybe changed for the technical reason without responsibility note, please feel free to contact technical Dept.

Grooved Concentric Reducer

沟槽式大小头

XGQT07

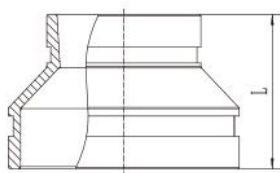

Nominal Size mm/in	Pipe OD. mm/in	Working Pressure psi/Mpa	Dimensions L mm/in
规格	管子基本尺寸	工作压力	尺寸
32×25 1¼×1	42.4×33.7 1.660×1.315	300 psi 2.07 Mpa	64 2.51
40×25 1½×1	48.3×33.7 1.900×1.315		64 2.51
40×32 1½×1¼	48.3×42.4 1.900×1.660		64 2.51
50×25 2×1	60.3×33.7 2.375×1.315		64 2.51
50×32 2×1¼	60.3×42.4 2.375×1.660		64 2.51
50×40 2×1½	60.3×48.3 2.375×1.900		64 2.51
65×25 2½×1	73.0×33.7 2.875×1.315		64 2.51
65×32 2½×1¼	73.0×42.4 2.875×1.660		64 2.51
65×40 2½×1½	73.0×48.3 2.875×1.900		64 2.51
65×50 2½×2	73.0×60.3 2.875×2.375		64 2.51
65×32 2½×1¼	76.1×42.4 3.000×1.660		64 2.51
65×40 2½×1½	76.1×48.3 3.000×1.900		64 2.51
65×50 2½×2	76.1×60.3 3.000×2.375		64 2.51
80×32 3×1¼	88.9×42.4 3.500×1.660		64 2.51
80×40 3×1½	88.9×48.3 3.500×1.900		64 2.51
80×50 3×2	88.9×60.3 3.500×2.375		64 2.51
80×65 3×2½	88.9×76.1 3.500×3.000		64 2.51
100×65 4×2½	108.0×76.1 4.250×3.000		76 2.99
100×80 4×3	108.0×88.9 4.250×3.500		76 2.99
100×32 4×1¼	114.3×42.4 4.500×1.660		76 2.99

Grooved Concentric Reducer

沟槽式大小头

XGQT07

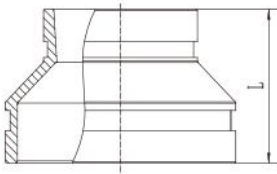

Nominal Size mm/in	Pipe OD. mm/in	Working Pressure psi/Mpa	Dimensions L mm/in
规格	管子基本尺寸	工作压力	尺寸
100×40 4×1½	114.3×48.3 4.500×1.900	300 psi 2.07 Mpa	76 2.99
100×50 4×2	114.3×60.3 4.500×2.375		76 2.99
100×65 4×2½	114.3×76.1 4.500×3.000		76 2.99
100×80 4×3	114.3×88.9 4.500×3.500		76 2.99
125×50 5×2	139.7×60.3 5.500×2.375		89 3.50
125×65 5×2½	139.7×76.1 5.500×3.000		89 3.50
125×80 5×3	139.7×88.9 5.500×3.500		89 3.50
125×100 5×4	139.7×114.3 5.500×4.500		89 3.50
125×50 5×2	141.3×60.3 5.563×2.375		89 3.50
125×65 5×2½	141.3×76.1 5.563×3.000		89 3.50
125×80 5×3	141.3×88.9 5.563×3.500		89 3.50
125×100 5×4	141.3×114.3 5.563×4.500		89 3.50
150×50 6×2	159.0×60.3 6.250×2.375		102 4.01
150×65 6×2½	159.0×76.1 6.250×3.000		102 4.01
150×80 6×3	159.0×88.9 6.250×3.500		102 4.01
150×100 6×4	159.0×108.0 6.250×4.250		102 4.01
150×100 6×4	159.0×114.3 6.250×4.500		102 4.01
150×125 6×5	159.0×133.0 6.250×5.250		102 4.01
150×125 6×5	159.0×139.7 6.250×5.500		102 4.01
150×50 6×2	165.1×60.3 6.500×2.375		102 4.01

注：产品尺寸可能会因技术原因有所改动，恕不另行通知，如有疑问请垂询金通管业技术部

The measurements of products may be changed for the technical reason without responsibility note, please feel free to contact technical Dept.



Grooved Concentric Reducer

沟槽式大小头

XGQT07

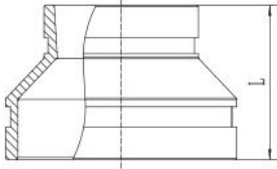

Nominal Size mm/in	Pipe OD. mm/in	Working Pressure psi/Mpa	Dimensions L mm/in
规格	管子基本尺寸	工作压力	尺寸
150×65 6×2½	165.1×76.1 6.500×3.000	300 psi 2.07 Mpa	102 4.01
150×80 6×3	165.1×88.9 6.500×3.500		102 4.01
150×100 6×4	165.1×114.3 6.500×4.500		102 4.01
150×125 6×5	165.1×139.7 6.500×5.500		102 4.01
150×50 6×2	168.3×60.3 6.625×2.375		102 4.01
150×65 6×2½	168.3×76.1 6.625×3.000		102 4.01
150×80 6×3	168.3×88.9 6.625×3.500		102 4.01
150×100 6×4	168.3× 114.3 6.625×4.500		102 4.01
150×80 6×5	168.3×139.7 6.625×5.500		102 4.01
200×50 8×2	219.1×60.3 8.625×2.375		127 5
200×65 8×2½	219.1×76.1 8.625×3.000		127 5
200×80 8×3	219.1×88.9 8.625×3.500		127 5
200×100 8×4	219.1×108.0 8.625×4.250		127 5
200×100 8×4	219.1×114.3 8.625×4.500		127 5
200×125 8×5	219.1×139.7 8.625×5.500		127 5
200×150 8×6	219.1×159.0 8.625×6.250		127 5
200×150 8×6	219.1×165.1 8.625×6.500		127 5
200×150 8×6	219.1×168.3 8.625×6.625		127 5

Threaded Concentric Reducer

螺纹式大小头

XGQT07S

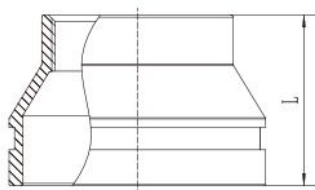

Nominal Size mm/in	Pipe OD. mm/in	Working Pressure psi/Mpa	Dimensions L mm/in
规格	管子基本尺寸	工作压力	尺寸
32×25 1¼×1	42.4×33.7 1.660×1.315	300 psi 2.07 Mpa	64 2.51
40×32 1½×1¼	48.3×42.4 1.900×1.660		64 2.51
50×25 2×1	60.3×33.7 2.375×1.315		64 2.51
50×32 2×1¼	60.3×42.4 2.375×1.660		64 2.51
50×40 2×1½	60.3×48.3 2.375×1.900		64 2.51
65×25 2½×1	73.0×33.7 2.875×1.315		64 2.51
65×32 2½×1¼	73.0×42.4 2.875×1.660		64 2.51
65×40 2½×1½	73.0×48.3 2.875×1.900		64 2.51
65×50 2½×2	73.0×60.3 2.875×2.375		64 2.51
65×25 2½×1	76.1×33.7 3.000×1.315		64 2.51
65×32 2½×1¼	76.1×42.4 3.000×1.660		64 2.51
65×40 2½×1½	76.1×48.3 3.000×1.900		64 2.51
65×50 2½×2	76.1×60.3 3.000×2.375		64 2.51
80×25 3×1	88.9×33.7 3.500×1.315		64 2.51
80×32 3×1¼	88.9×42.4 3.500×1.660		64 2.51
80×40 3×1½	88.9×48.3 3.500×1.900		64 2.51
80×50 3×2	88.9×60.3 3.500×2.375		64 2.51
80×65 3×2½	88.9×76.1 3.500×3.000		64 2.51
100×25 4×1	108.0×33.7 4.250×1.315		76 2.99
100×32 4×1¼	108.0×42.4 4.250×1.660		76 2.99
100×40 4×1½	108.0×48.3 4.250×1.900		76 2.99
100×50 4×2	108.0×60.3 4.250×2.375		76 2.99
100×65 4×2½	108.0×76.1 4.250×3.000		76 2.99
100×80 4×3	108.0×88.9 4.250×3.500		76 2.99

注：产品尺寸可能会因技术原因有所改动，恕不另行通知，如有疑问请垂询金通管业技术部

The measurements of products maybe changed for the technical reason without responsibility note, please feel free to contact technical Dept.

Threaded Concentric Reducer

螺纹式大小头
XGQT07S

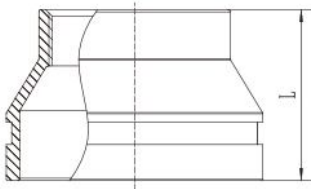

Nominal Size mm/in	Pipe OD. mm/in	Working Pressure psi/Mpa	Dimensions L mm/in
规格	管子基本尺寸	工作压力	尺寸
100×25 4×1	114.3×33.7 4.500×1.315	300 psi 2.07 Mpa	76 2.99
100×32 4×1¼	114.3×42.4 4.500×1.660		76 2.99
100×40 4×1½	114.3×48.3 4.500×1.900		76 2.99
100×50 4×2	114.3×60.3 4.500×2.375		76 2.99
100×65 4×2½	114.3×76.1 4.500×3.000		76 2.99
100×80 4×3	114.3×88.9 4.500×3.500		76 2.99
125×25 5×1	133.0×33.7 5.250×1.315		89 3.50
125×32 5×1¼	133.0×42.4 5.250×1.660		89 3.50
125×40 5×1½	133.0×48.3 5.250×1.900		89 3.50
125×50 5×2	133.0×60.3 5.250×2.375		89 3.50
125×25 5×1	139.7×33.7 5.500×1.315		89 3.50
125×32 5×1¼	139.7×42.4 5.500×1.660		89 3.50
125×40 5×1½	139.7×48.3 5.500×1.900		89 3.50
125×50 5×2	139.7×60.3 5.500×2.375		89 3.50
125×65 5×2½	139.7×76.1 5.500×3.000		89 3.50
125×80 5×3	139.7×88.9 5.500×3.500		89 3.50
125×100 5×4	139.7×114.3 5.500×4.500		89 3.50
125×25 5×1	141.3×33.7 5.563×1.315		89 3.50
125×32 5×1¼	141.3×42.4 5.563×1.660		89 3.50
125×40 5×1½	141.3×48.3 5.563×1.900		89 3.50
125×50 5×2	141.3×60.3 5.563×2.375		89 3.50
125×65 5×2½	141.3×76.1 5.563×3.000		89 3.50
125×80 5×3	141.3×88.9 5.563×3.500		89 3.50
150×25 6×1	159.0×33.7 6.250×1.315		102 4.01

Threaded Concentric Reducer

螺纹式大小头

XGQT07S

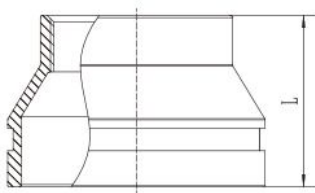

Nominal Size mm/in	Pipe OD. mm/in	Working Pressure psi/Mpa	Dimensions L mm/in
规格	管子基本尺寸	工作压力	尺寸
150×32 6×1¼	159.0×42.4 6.250×1.660	300 psi 2.07 Mpa	102 4.01
150×40 6×1½	159.0×48.3 6.250×1.900		102 4.01
150×50 6×2	159.0×60.3 6.250×2.375		102 4.01
150×65 6×2½	159.0×76.1 6.250×3.000		102 4.01
150×80 6×3	159.0×88.9 6.250×3.500		102 4.01
150×25 6×1	165.1×33.7 6.500×1.315		102 4.01
150×32 6×1¼	165.1×42 6.500×1.660		102 4.01
150×40 6×1½	165.1×48.3 6.500×1.900		102 4.01
150×50 6×2	165.1×60.3 6.500×2.375		102 4.01
150×65 6×2½	165.1×76.1 6.500×3.000		102 4.01
150×80 6×3	165.1×88.9 6.500×3.500		102 4.01
150×100 6×4	165.1×114.3 6.500×4.500		102 4.01
150×25 6×1	168.3×33.7 6.625×1.315		102 4.01
150×32 6×1¼	168.3×42.4 6.625×1.660		102 4.01
150×40 6×1½	168.3×48.3 6.625×1.900		102 4.01
150×50 6×2	168.3×60.3 6.625×2.375		102 4.01
200×25 8×1	219.1×33.7 8.625×1.315		127 5
200×32 8×1¼	219.1×42.4 8.625×1.660		127 5
200×40 8×1½	219.1×48.3 8.625×1.900		127 5
200×50 8×2	219.1×60.3 8.625×2.375		127 5
200×65 8×2½	219.1×76.1 8.625×3.000		127 5
200×80 8×3	219.1×88.9 8.625×3.500		127 5
200×100 8×4	219.1×114.3 8.625×4.500		127 5

注：产品尺寸可能会因技术原因有所改动，恕不另行通知，如有疑问请垂询金通管业技术部

The measurements of products maybe changed for the technical reason without responsibility note, please feel free to contact technical Dept.



Grooved Eccentric Reducer
沟槽式偏心大小头
XGQT07P

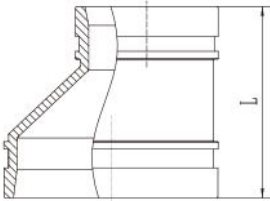

Nominal Size mm/in	Pipe OD. mm/in	Working Pressure psi/Mpa	Dimensions L mm/in
规格	管子基本尺寸	工作压力	尺寸
80×50 3×2	88.9×60.3 3.500×2.375	300 psi 2.07 Mpa	89 3.50
100×65 4×2½	108.0×76.1 4.250×3.000		102 4.01
100×80 4×3	108.0×88.9 4.250×3.500		102 4.01
100×50 4×2	114.3×60.3 4.500×2.375		102 4.01
100×65 4×2½	114.3×76.1 4.500×3.000		102 4.01
100×80 4×3	114.3×88.9 4.500×3.500		102 4.01
125×80 5×3	139.7×88.9 5.500×3.500		102 4.01
125×100 5×4	139.7×114.3 5.500×4.500		102 4.01
150×80 6×3	159.0×88.9 6.250×3.500		102 4.01
150×100 6×4	159.0×108.0 6.250×4.250		102 4.01
150×100 6×4	159.0×114.3 6.250×4.500		102 4.01
150×65 6×2½	165.1×76.1 6.500×3.000		102 4.01
150×80 6×3	165.1×88.9 6.500×3.500		102 4.01
150×100 6×4	165.1×114.3 6.500×4.500		102 4.01
150×125 6×5	165.1×139.7 6.500×5.500		102 4.01
150×80 6×3	168.3×88.9 6.625×3.500		102 4.01
150×100 6×4	168.3×114.3 6.625×4.500		102 4.01
150×80 6×3	168.3×139.7 6.625×5.500		102 4.01
200×80 8×3	219.1×88.9 8.625×3.500		127 5
200×100 8×4	219.1×114.3 8.625×4.500		127 5
200×125 8×5	219.1×139.7 8.625×5.500		127 5
200×150 8×6	219.1×165.1 8.625×6.500		127 5
200×150 8×6	219.1×168.3 8.625×6.625		127 5

Adaptor Flange ANSI Class 150

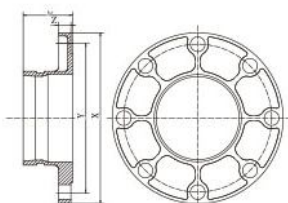
转换法兰
XGQT08

Nominal Size mm/in	Pipe OD. mm/in	Working Pressure psi/Mpa	Dimensions mm/in				Bolt/Size No.-Size mm
			L mm/in	X mm/in	Y mm/in	Z mm/in	
规格	管子基本尺寸	工作压力	尺寸				螺栓
50 2	60.3 2.375	300 psi 2.07 Mpa	60 2.362	160 6.30	120.7 4.75	15 0.59	4-5/8
65 2½	73 2.875		60 2.362	180 7.08	139.7 5.50	15 0.59	4-5/8
80 3	88.9 3.5		65 2.559	200 7.87	152.5 6.00	15 0.59	8-5/8
100 4	114.3 4.5		70 2.756	228 8.97	190.5 7.50	16 0.63	8-5/8
100 4	141 4.5		70 2.756	250 9.84	216 8.50	17 0.67	8-5/8
150 6	168.3 6.625		70 2.756	282 11.10	241.5 9.50	17 0.67	8-3/4
200 8	219.1 8.625		75 2.952	340 13.39	298.5 11.75	19 0.74	8-3/4
250 10	273 10.75		85 3.346	405 15.94	362 14.25	21 0.82	12-7/8
300 12	323.9 12.750		85 3.346	482 18.97	432 17.00	22 0.86	12-7/8

注：产品尺寸可能会因技术原因有所改动，恕不另行通知，如有疑问请垂询金通管业技术部

The measurements of products may be changed for the technical reason without responsibility note, please feel free to contact technical Dept.



Adaptor Flange PN 16

转换法兰 XGQT08

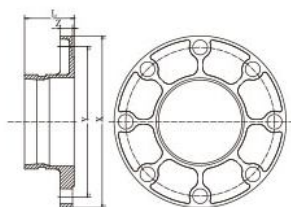

Nominal Size mm/in	Pipe OD. mm/in	Working Pressure psi/Mpa	Dimensions mm/in				Bolt Size No.-Size mm
			L mm/in	X mm/in	Y mm/in	Z mm/in	
规格	管子基本尺寸	工作压力	尺寸				螺栓
50 2	60.3 2.375	232psi 1.6Mpa	65 2.559	165 6.50	125 4.92	16 0.63	4-M 16
65 2½	76.1 3		65 2.559	185 7.28	145 5.70	16 0.63	4-M 16
80 3	88.9 3.5		65 2.559	200 7.87	160 6.29	16 0.63	8-M 16
100 4	108 4.25		70 2.756	220 8.66	180 7.08	16 0.63	8-M 16
100 4	114.3 4.5		70 2.756	220 8.66	180 7.08	16 0.63	8-M 16
125 5	133 5.25		70 2.756	250 9.84	210 8.26	18 0.71	8-M 16
125 5	139.7 5.5		70 2.756	250 9.84	210 8.26	18 0.71	8-M 16
150 6	159 6.25		70 2.756	282 11.10	240 9.44	18 0.71	8-M 20
150 6	165.1 6.5		70 2.756	282 11.10	240 9.44	18 0.71	8-M 20
150 6	168.3 6.625		70 2.756	282 11.10	240 9.44	18 0.71	8-M 20
200 8	219.1 8.625		80 3.150	340 13.39	295 11.61	19 0.74	12-M 20
250 10	273 10.75		85 3.346	405 15.94	355 13.97	21 0.82	12-M 24
300 12	323.9 12.750		90 3.543	460 18.11	410 16.14	24 0.94	12-M 24

橡胶密封圈 (GASKET DATA)



牌号名称 Gasket	名称 Name	适用温度 Temperature Range	使用介质 General Service Recommendations	颜色标记 Color Mark
E	三元 乙丙 橡胶 EPDM	-34~+110°C (-30~+230°F)	水、气体、稀释的酸（碱）、以及其他化学品（不包括碳氢化合物。） 注：严禁与油、碳氢化合物同用。 Recommended for hot water service within the specified temperature range plus a variety of dilute acids, oil-free air and many chemical services. UL classified in accordance with ANSI/NSF 61 or cold+86° F (+30°) and hot +180° F (+82° C) potable water service. Not recommended for petroleum service	黑色加绿色标记 Green Strip
S	硅橡胶 SILICON	-40~+177°C (-40~+350°F)	高温干燥的空气和一些高温的化学物，饮用水等。（ Recommended for high temperature dry air and some high temperature chemical products,drinking water,etc.）	白色 White
D	丁腈 橡胶 NITRILE	-29~+82°C (-20~+180°F)	石油产品、植物油、矿物油 注：严禁与高温物质同用。 Recommended for petroleum products, air with oil vapors, vegetable and mineral oils within the specified temperature range. Not recommended for hot water services.	黑色加橙色标记 Orange Strip

注：产品尺寸可能会因技术原因有所改动，恕不另行通知。如有疑问请垂询金通管业技术部

The measurements of products maybe changed for the technical reason without responsibility nota,please feel free to contact technical Dept.

刚性&挠性卡箍安装指南

Installation Instruction For Rigid & Flexible Coupling

1. 刚性管接头连接:

刚性管接头连接方式使系统不具柔性，管接头卡紧后可与钢管形成刚性一体，在吊具跨度较大时，使管道依靠自身刚性支撑连接。

Rigid Couplings can not enable the connection system to be flexible, and the couplings are integrated with steel pipes after they are fastened. If the sling has a bigger span, the pipes will support the connection depending on their own rigidity.

2. 柔性管接头连接: 柔性管接头连接方式使系统具有柔性，允许钢管有一定的角度偏差，相对错位。钢管连接后，两钢管管端之间留有间隙可适应管道的膨胀、收缩。管接头末端载荷的能力。末端负荷是指管接头槽口可承受沿钢管轴向负荷的能力。

Flexible Couplings can enable the connection system to be flexible ,it allows the steel pipe has a certain angle deviation and relative deviation .There are some clearance between the ends of two steel pipes in order to suit the expansion and shrinkage of the pipelines. The pipe couplings should maintain the normal working condition under the maximum allowable deflexion and dislocation .Flexible Couplings can endure a certain terminal load, which refers to the load along the pipe axis to be borne by coupling grooves.



1. 安装前必须检查沟槽是否符合标准，去掉管子和密封圈上的毛刺、铁锈，油污等杂质。

1. Before installation, whether the groove meet the standard should be checked and then wipe away the pickles, iron rust, greasy dirt on gasket ring and pipe.



2. 在管子端部和橡胶圈上涂上润滑剂
2. Spread lubricant on the pipe end and gasket ring.



3. 将密封橡胶圈套入一根钢管的密封部位
3. Cover the compacting gasket ring at the sealing of a steel pipe.



4. 将另一根加工好沟槽的钢管靠拢，将橡胶圈套入管端，使橡胶圈刚好位于两根管子的密封部位。

4. Secure another grooved steel pipe to this one and cover the gasket ring on pipe end, making sure the gasket ring at the sealing position of both pipes.



5. 确认管卡已经卡住管子。
5. Make sure coupling has fixed the pipes.



6. 均匀的拧紧全部标准螺栓，直到达到要求的扭矩值
6. Gradually tighten nuts to torque.

jinton 金通 *Best quality ⇨ Cross the world*

SHANDONG JINTONG PIPELINE CO.,LTD

山东金通管业有限公司

Add: No. 6 Yuhe Industrial Park, Weicheng District,
Weifang, Shandong, China 261057

Tel: +86 536 8163036/8167157

Fax: +86 536 8165618

Email: sales@jinton.cc

Http://www.jinton.cc

2015.5